

CKL-CHP SERIES

CARBON STEEL HIGH PRESSURE SEP.

operating pressure	100, 250, 400 bar
volume flow rate	40 to 715 Nm³/h
connections	1/4" to 2"
operating temp. range	1,5 to 65 °C
surface protection	Nickel plated 25 µm

APPLICATIONS

- general industrial applications
- automotive
- electronics
- food and beverage
- chemical
- petrochemical
- plastics
- paint

DESCRIPTION

CKL-CHP condensate separators are designed for high efficient removal of bulk liquids from compressed air systems. Condensate separator element inside the housing separates already liquified water from mainstream and prevents the liquids and large particles from being airborne again.

To discharge condensate from the CKL-CHP condensate separator it is essential to install automatic or electronic condensate drain.



VALVE





TECHNICAL DATA

Filter housing size	Pipe size	Max. oper. pressure	Flow rate at 7 bar(g), 20 °C		Temperature oper. range		Dimensions [mm]			Mass
	inch		bar/psi	Nm ³ /h	scfm	°C	°F	A	B	
CKL-CHP 003	1/4"	100/250/400	40	23,5	1,5 - 65	35 - 149	165	83,5	70	4,6
CKL-CHP 005	3/8"	100/250/400	70	41,2	1,5 - 65	35 - 149	165	83,5	70	4,6
CKL-CHP 007	1/2"	100/250/400	130	76,5	1,5 - 65	35 - 149	210	105	85	8,7
CKL-CHP 010	3/4"	100/250/400	195	115	1,5 - 65	35 - 149	210	105	85	9,3
CKL-CHP 018	1"	100/250/400	275	162	1,5 - 65	35 - 149	253	119	100	11,6
CKL-CHP 030	1 1/4"	100/250/400	380	223	1,5 - 65	35 - 149	303	119	100	16
CKL-CHP 047	1 1/2"	100/250/400	495	291	1,5 - 65	35 - 149	329	146	130	26,5
CKL-CHP 094	2"	100/250/400	715	421	1,5 - 65	35 - 149	415	182	150	49

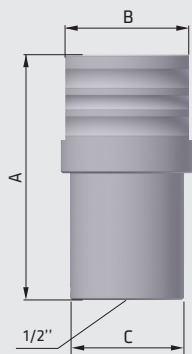

quality class - solids (ISO 8573-1)	-
quality class - water (ISO 8573-1)	8
quality class - oils (ISO 8573-1)	-
efficiency	>98%

CORRECTION FACTORS

Operating pressure [bar]	7	25	40	64	100	250	400
Operating pressure [psi]	100	362	580	928	1450	3625	5800
Correction factor	1	3	5	8	12	12	12